

DOUBLE ELEMENT SUMP FILTERS

REPLACES PRODUCTS FOR:
Michigan Fluid Power (MFP)
Fluid Power Products
Ambac Fluid Power
Fluid Power Systems

These high-quality sump filters meet the special requirements for use with hydraulic oils, coolants, lubricants, and fire-resistant fluids. They have a

unique dual-element construction that provides a much larger filtering area than standard units. This greater filtration capacity makes them ideal for use in the following industries: agriculture, construction, general industrial, material handling, chemical, petroleum, machine tool & metalworking, and processing.

GPM	PORT SIZE NPT	ELEMENT AREA SQ. IN.	HEX A	B	C	D
10	1	130	1-5/8	4-1/16	3-1/8	3
15	1	170	1-5/8	5-1/16	4-1/8	3
20	1-1/4	230	2	6-1/16	5-1/8	3
30	1-1/2	370	2-1/4	6-1/16	5-1/8	4
50	2	450	2-3/4	7-1/16	6-1/8	4
75	2-1/2	540	3-9/16	7-1/16	6-1/4	5
100	3	720	4	8-5/16	7-1/4	5
150	3	920	4	10-5/16	9-1/4	5

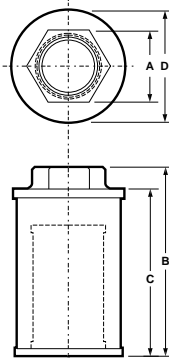

HOW TO ORDER DUAL ELEMENT SUMP FILTERS

Select the desired specifications from the data below and build an ordering code number, as shown in the example:

SR - 75 - 2-1/2 - 100 - RV-3
 STYLE - GPM - NPT - MESH - VALVE
 (omit if not wanted)

STYLE	GPM (Flow Capacity)	NPT (Pipe Size)	MESH (Screen Size)	VALVE (Optional)
SU	10	1	60	RV-3 (3-psi bypass)
without bypass	15	1		
SR	20	1-1/4	100	
with bypass	30	1-1/2		
	50	2		
	75	2-1/2		
	100	3		
	150	3		

(Pressure drop through a clean element will not exceed 0.2 psi (0.4-in. Hg) at rated flow of 150 SSU viscosity fluid and 100 mesh.)

Magnets are available, order separately.

Magnets Available- See Page 14

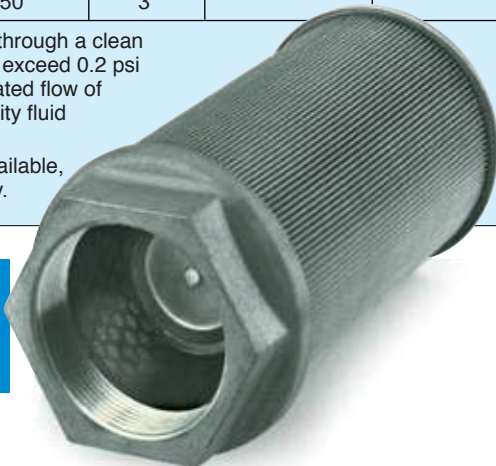

SUCTION STRAINERS

"WASS" style sump strainers are mini-type, welded, and all 304 stainless steel for virtually any fluid compatibility issues. The ends are secured through mechanical crimping. No epoxy is used in the manufacturing of these units. For low-flow applications.

HOW TO ORDER

Select the desired specifications from the ordering table and build an ordering code number, as shown in this example:

WASS - 3 - 1/2 - NIP - 60 - RV-3
 STYLE - GPM - NPT - CONNECTION - MESH - VALVE
 (spell out NIP if wanted) (omit if not wanted)

STYLE	GPM (Flow Capacity)	NPT (Pipe Size)	CONNECTION (Nut or Nipple)	MESH (Screen Size)	VALVE (Optional)
WASS	3	3/8	no symbol (coupling)	30	no symbol (omitted)
		1/2	NIP (nipple)	60	RV-3 (3-psi)
		3/4*		100	RV-5 (5-psi)
				200**	

* 3/4 coupling not available
 ** 50 x 200 mesh available

NPT	LENGTH	
	COUPLING	NIPPLE
3/8	3-1/16	3-1/2
1/2	3-1/4	3-1/2
3/4	N/A	3-1/2

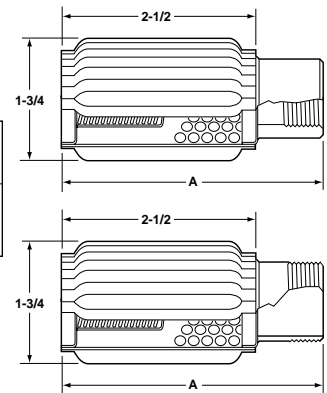

WASS Nipple



WASS Coupling